

# Securescript





Security & Convenience

## Content

1. What is *Nurugo* ?
2. Why *Nurugo* ?
3. Various Solutions
  - Partnership Model
  - Enterprise Model
4. *Nurugo* Components
5. Values Proposition
6. Business Partnership Establishment
7. Technology

# 1. What is *Nurugo* ?

---



**An attachable input device to provide fingerprint recognition function on Smartphones, Tablets, Laptops, etc. that do not have fingerprint authentication modules.**



Black

Blue

Pink

Red

Yellow

Green

## 2. Why *Nurugo* ?

- ① A fingerprint recognition input device that makes use of the camera and LED lighting, which every Smartphone, Tablet, Laptop, etc. already has.

### Smartphone



### Camera Lighting

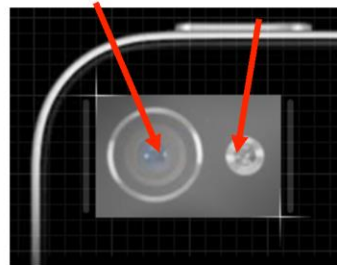

### Tablet



### Tablet



Applicable to various devices

## 2. Why *Nurugo* ?

- ② No power consumption or cable connection while other companies' fingerprint recognition products only work through external connection with cables.



*Nurugo*

consists of only optical parts♪

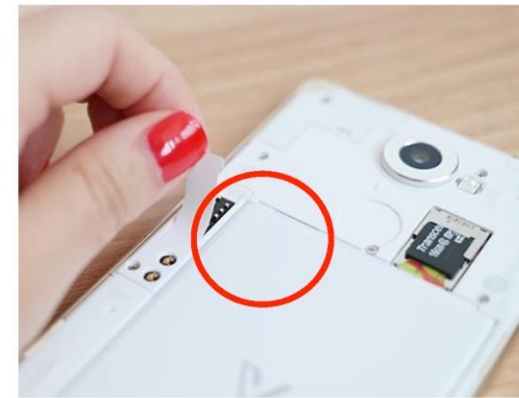

Others♪



## 2. Why *Nurugo* ?

---

③ Costs only 1/10 of other fingerprint input sensors.



## 2. Why *Nurugo* ?



### *Nurugo* recognizes the same fingerprint

-Other companies' Built-in fingerprint modules can't recognize the same finger when you register your fingerprint

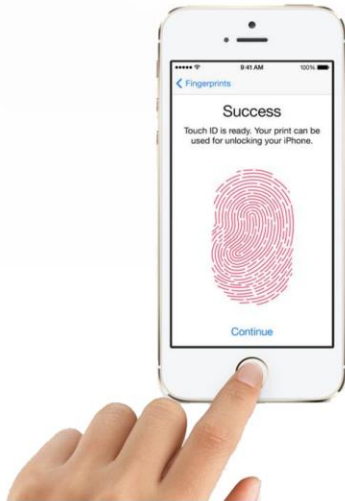

Cat's footprint

## 2. Why *Nurugo* ?

### ⑤ *Nurugo* is very strong against wet fingerprints

- Products with embedded fingerprint recognition modules are vulnerable to wet fingerprints which cause authentication fail after washing hands or sweating.



Unchanged fingerprint authentication rate in the rain♪



## 2. Why *Nurugo* ?

---

### ⑥ No patent infringement

*Nurugo*'s fingerprint recognition method is  
an **independent technology**"

<Summary of Authentec's "method and apparatus for creating a composite fingerprint image patent">

Domestic registration number 10-0818416 / International application number PCT/US2000/012784

A method and apparatus generates fingerprint data for a fingerprint area larger than a sensing area of a fingerprint sensor. A fingerprint of a user is enrolled by generating fingerprint data sets responsive to placing a finger of a user on a sensing area of the fingerprint sensor a plurality of times with the finger being slightly repositioned on successive placements. (omit)

▷ Due to the above patent, every Swipe type sensor is not free from Patent infringement.

### 3. Various Solutions – Partnership Model

#### Beyond protection and security



Screen Lock



Book mark



Gallery Lock



App. Lock



### 3. Various Solutions – Enterprise Model

## Providing an advanced security solution for BYOD (Bring Your Own Device)



### Mobile Device Management

- Identify the user
- Validate the device
- Control the access per user
- Control the access to security system

